

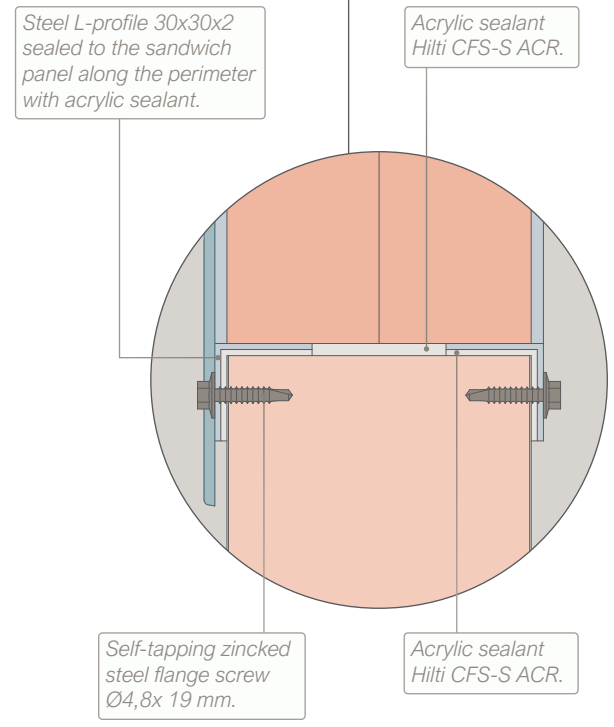

CR2 FIRE DAMPER

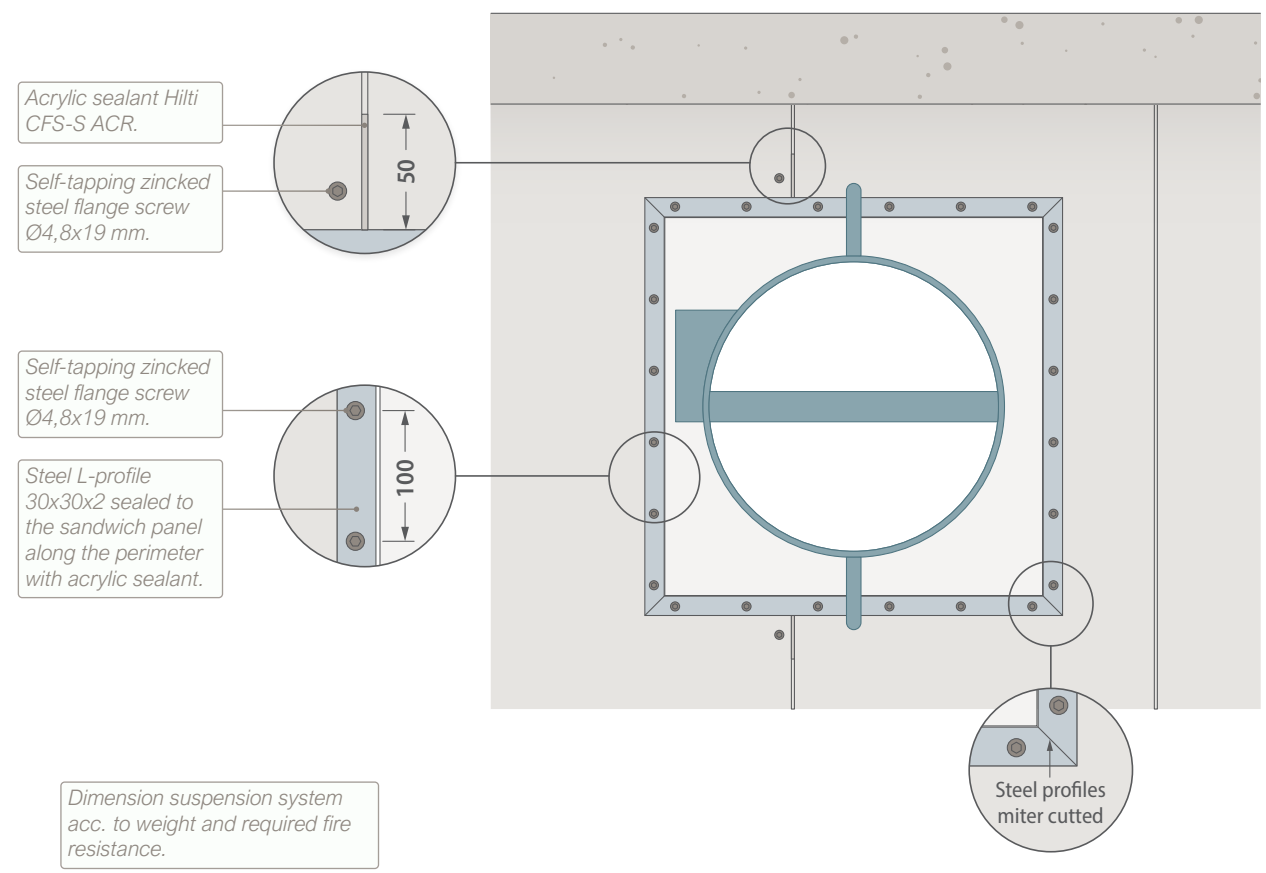
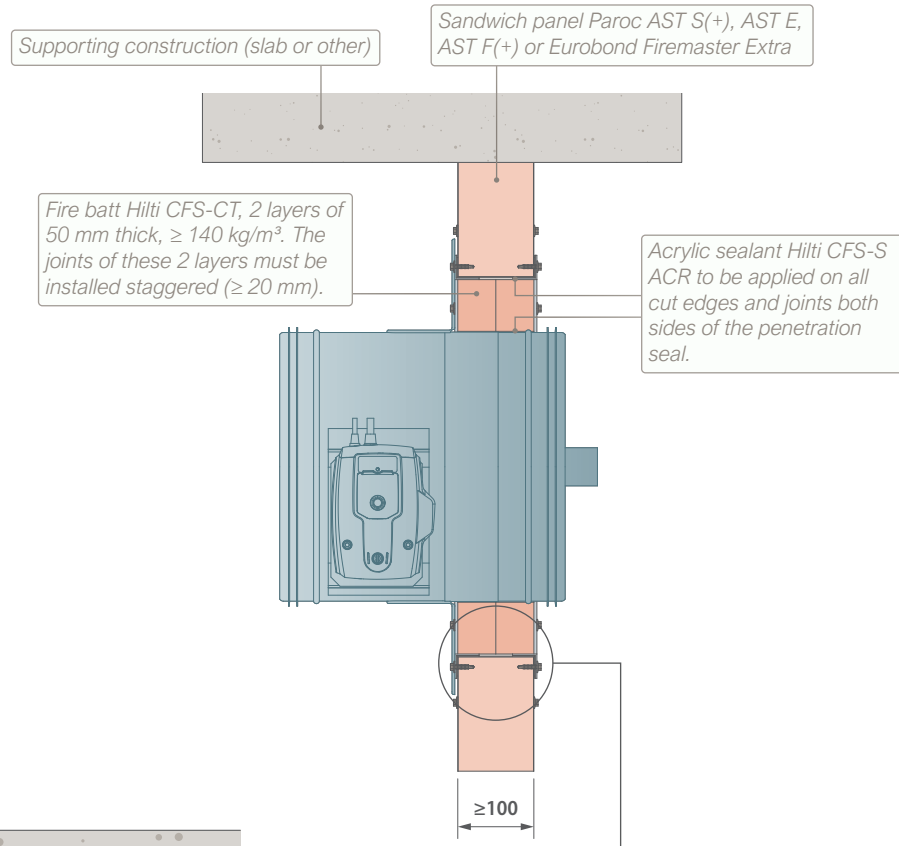
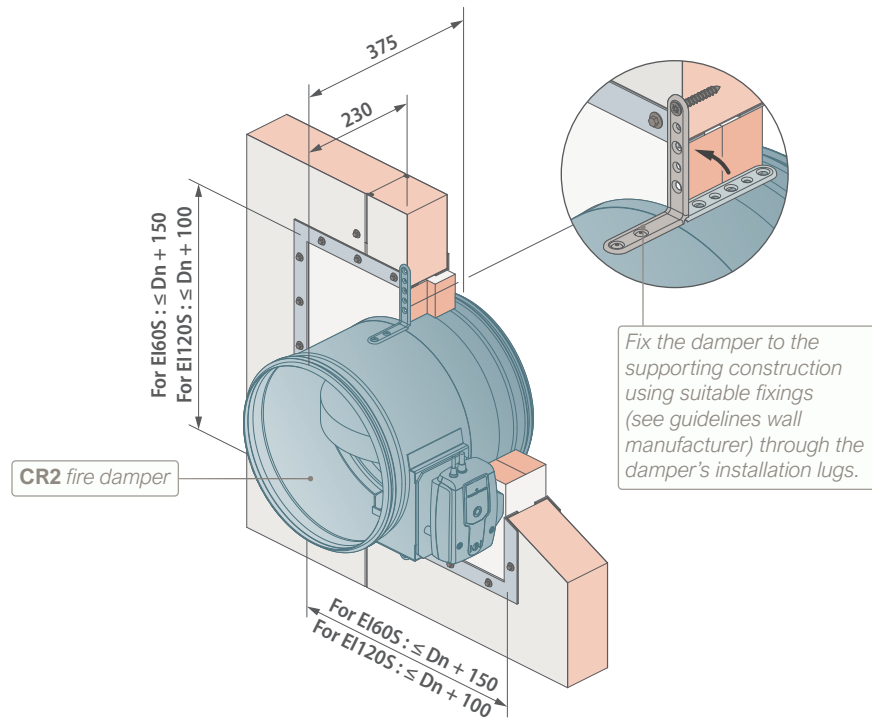

TECHNICAL FEATURES

- Damper range: ø200 till 630.
 - Damper can be installed with blade in horizontal position.
- 
- Damper can be installed with mechanism on either side of the wall (independent of fire side).
 - Please consult with the fire batt manufacturer for appropriate sealant/coating
 - To be read in conjunction with the CR2 Fire Damper Technical Datasheet (QR code below).
 - Guidelines acc. to DW144/145 (not required for CE):
 - Installation lugs as shown in the drawings are available upon request.
 - Provide appropriate break-away / flexible joint between fire damper and connecting ductwork on both sides of the assembly (DW145: eg socket & spigot or flanged with appropriate fixings eg plastic cleats, clips, clamps, bolts, aluminium alloy rivets etc.).
 - Provide a panel in the adjacent ductwork to allow access to the internal components of the fire damper.
 - Ductwork must be independently supported and installed (DW144).
 - Dimensions in mm unless otherwise stated.
 - Sandwich panel thickness $\geq 100\text{mm}$, covering 100, 120, 125, 150, 175, 200, 240 and 300mm.

TECHNICAL DATASHEET



INSPECTION AND HANDOVER CHECK LIST



PLAN TITLE

CR2 fire damper in sandwich wall panel.
Installation detail with fire batt.

CLASSIFICATION

EI 60/120 (ve i↔o)S



REV
B

DATE
26/11/2024

